

Installation and Operating Instructions

Zip HydroTap® C125+

Filtered chilled drinking water for kitchens and tea rooms.

Affix Model Number Label Here
81894



This Installation Instruction covers the following HydroTap models:
Hydrotap Chiller Only C125+ and associated Disabled model.



Contents

Contents	1
Installation Check List	2
Technical Data	2
Read These Warnings First	3
Models Covered by These Instructions	4
Installation Requirements	4
Special Tools Required	5
Installation Procedure	5
Step A - Installing the Tap	5
Step B - Installing the Undersink Unit	6
See special note page 6, ventilation buffers.	
Step C - Connecting the Tap,	6
Step D - Connecting the Water Supply	7
Step E - Testing and Commissioning	7
Font Installation Procedure	8
Operating the Tap	9
Cleaning	10
Replacing the Filter	10
Setting the Energy Saver Timer	11
Auxiliary Fan Attachment	12
Set Cold Water Dispensing Time	12
Trouble Shooting	13
End of Life Disposal	13
Exploded View Chiller Module and Spares	14
Notes	15
Notes	16
Warranty Information	17
Contact Details	17

NOTE:

Read all instructions and precautions before proceeding. If in doubt, or need further guidance, please call Zip on 0800 077 8302

Please leave these instructions with the end user after installation.

This unit must be installed in accordance with water supply byelaws, current IEC regulations and relevant local authority byelaws.

Installation Checklist

Before Installation:

- A. Read the instructions.
- B. Note: Not all fittings are supplied with the appliance kit. Isolation valves are not supplied.
- C. Check the water pressure to determine if you require a pressure reduction valve or a flow restrictor added or removed from the kit.
- D. Check the water quality to determine if extra filtration will be required.
- E. Check the appliance rating plate and ensure correct power is available for the appliance.
- F. Check the under counter cupboard supporting the appliance is adequate for the total weight of the appliance, when full of water (32.5 kg when full).

Before Commissioning:

- 1. Check the unit has been installed correctly.
- 2. Check all plumbing fittings have been tightened.
- 3. Ensure there is adequate ventilation.
- 4. Check all tubes from the undersink unit to the tap, have a constant rise and there are no sags or kinks in the hoses.
- 5. Check all electrical connections are correct and there are no loose wires.

Commission:

- 6. Flush the supply line before connecting.
- 7. Turn on the water and check for leaks.
- 8. Flush the internal filter.

Technical data

Delivery rate: Up to 18 glasses of water at a time. (The standard glass is 200 ml)

Rating: 0.3kW @ 230V AC.

Refrigerant: R134A.

Tap head: Chrome plated, die cast tap body with push and pull levers for electronically controlled water delivery, integral LED indicators.

Disabled option: Oversize tap levers.

Under counter unit: Houses chilled and filtration systems. Corrosion resistant white enamelled steel case, with front access door.

Control panel: Located on under counter unit to control timer and water delivery.

Filtration system: Integral triple-action, submicron, encapsulated cartridge.

Safety features: Undercounter safe tray with leak detector.

Dimensions: Width: 305mm, Depth: 455mm, Height: 340mm.

Weight: Empty: 26 kg - Full: 32.5 kg.

Approvals: WRAS, CE endorsed.

Please leave these instructions with the end user after installation.

Read These Warnings First

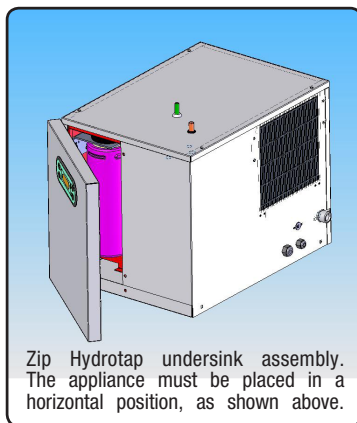
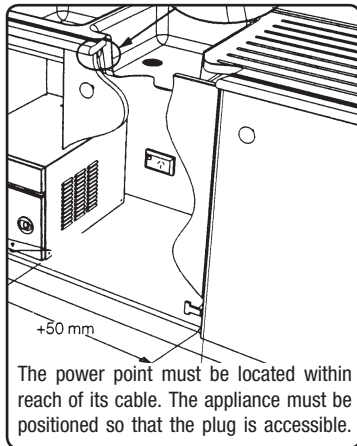

Note:

Always ensure the hoses are shortened so that any excess is removed and their route is the most direct line between the tap assembly and the HydroTap unit.

Do not allow the hoses to sag or droop so water is trapped within the hoses.

Always maintain a constant fall back to the unit.

Positioning of the tap assembly must be within the following parameters:

The height between the base of the Hydrotap unit and the base of the Tap assembly cannot be greater than 900mm.

Safety

Do not allow young children, handicapped or infirm persons, to use the Zip HydroTap without supervision.

Refrigerant

The Zip HydroTap Chilling unit contains 134A refrigerant under pressure. No part of the unit should be exposed to a naked flame. Maintenance of the refrigeration unit must be carried out by an accredited service provider or qualified refrigeration mechanic.

Qualifications

If any power cord or plug is damaged it must be repaired only by a qualified technician. To avoid hazards, all installation procedures must be carried out by a suitably qualified trades person. The power cable and power outlet must be in a safe visible position for connection.

Lifting

Take care when lifting the Zip HydroTap undersink unit. Some units may exceed safe lifting limits. Do not lift without assistance. The weights of the units are given in the table under the heading "Installation Requirements". Do not lift the unit by the doors.

Airflow

The ambient temperatures this unit should operate within are 5 °C - 35 °C. Proper air circulation must be provided. The system will operate satisfactorily only if the recommended air gaps are provided, these are 50mm minimum side clearance and 65mm rear clearance. An air vent is provided with each unit for high usage applications, this must be installed in the top half of the cupboard door as a matter of course. An auxiliary fan kit is available and should be used to ensure adequate ventilation. Make sure that the ventilation grilles of the undersink unit are not obstructed. Included in the installation pack are adhesive backed silicon buffers. If air vents are not installed in the cupboards housing the HydroTap, the buffers must be placed on the inside edge of the cupboard door to create a slight gap ensuring a minimum airflow. Failure to do this may cause the HydroTap to overheat and operate inefficiently.

Filter Control

The Zip HydroTap filter control is preset to 6000 Litres to provide trouble-free flow and operation in most installations. Local water quality conditions may require an alteration to this capacity. In areas where the water has a high concentration of sediment, the preset litre capacity may be shortened to avoid poor flow, taste or odour situations. In areas where the water quality is above average, lengthening the preset capacity may be desirable, but not essential. If any of these changes are needed, follow the instructions on page 11 or contact your Zip Service Provider.

Read These Warnings continued

Frost Protection

If this appliance is located where the ambient air temperature could fall below 5 °C when the chiller is not in use, do not turn off the appliance electrically. This safeguard does not offer the same protection to the connecting pipe work and fittings.

Installation Environment Considerations

This unit is intended for indoor use only and should never be installed outdoors or exposed to the elements. This unit must not be positioned in an area that may be cleaned by a water jet. This unit must not be cleaned by a water jet.

Model covered by these instructions

C	125
Model	Glasses of Chilled Water per Hour

The standard glass is 200 ml (7 fl oz).

These installation instructions cover the C125+ model HydroTap and associated Disabled model.

When correctly installed, operated and maintained in accordance with these instructions, the Zip C125+ HydroTap is intended to deliver filtered chilled water for consumption.

Installation Requirements

Before installing ensure that the following have been provided at the installation site:

- Sufficient space in the cupboard to install the undersink unit in accordance with these Installation Instructions. A table of dimensions is given below.

Model	Height mm (inch)	Depth mm (inch)	Width mm (inch)	Weight empty kg's lbs	Weight full kg's lbs
C125+ Chiller	340 (13.4)	455 (18)	305 (12)	26 (57.3)	32.5 (71.6)



NOTE: Add 65mm to the Width of the undersink unit to allow for Water and Electrical connections.

- A water supply connection with isolating valve (not supplied) inside the cupboard within reach of the 750 mm flexible connection and positioned so that the connection point and the stop cock will not be obstructed when the undersink unit is installed.
- Power supply 220-240 Volt AC, for connection to the chiller via a 13 amp fused spur.
- This switch must provide all-pole disconnection and a contact separation of at least 3mm installed in accordance with IEE wiring regulations.
- Cold water supply with a minimum working pressure of 0.07 MPa (0.7 bar) and a maximum working pressure of 0.7 MPa (7 bar) connected via an isolation valve. If pressure is likely to exceed 0.7 MPa (7 bar), install a 0.35 MPa (3.5 bar) Pressure Limiting Valve (Zip accessory AQ3 combined pressure reducer and line strainer).

Installation Requirements continued

- The fitting of an air flow vent cut into the top half of the cupboard door concealing the HydroTap requiring a cut size of approximately 100mm circular, to provide adequate warm air displacement. In installations where high volume draw-off will occur, the fitting of the accessory exhaust fan is essential.

Important: Do not proceed with the installation if these requirements are not met.

Special tools required

In addition to normal tools, the following will be required:

- 35mm diameter sheet metal hole punch for sink tops. (Not supplied)
- 35mm diameter hole saw for timber bench tops. (Not supplied)
- Nut runner tube spanner (supplied) for fixing tap assembly.

When installing a Font unit:

- 108mm diameter sheet metal or hole saw to suit surface being cut.

Installation procedure

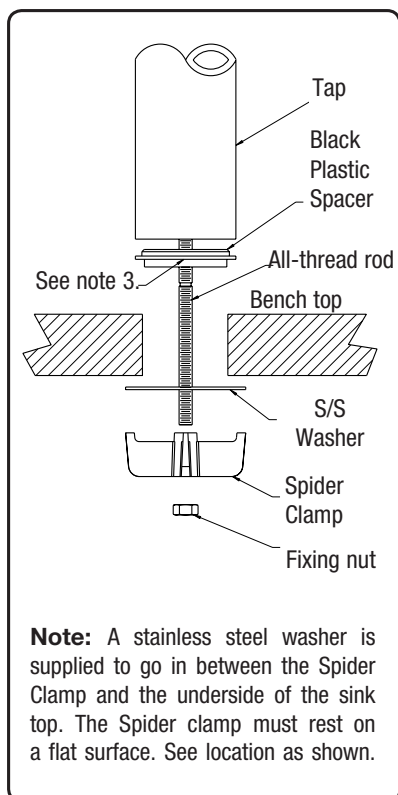

Step A - Installing the tap

1. Make sure that the tap location will allow the nozzle to drain into the sink.
2. Install the 35mm hole in the bench / sink top.
3. Ensure the black plastic spacer remains in place as this is the moisture seal against the bench / sink top. A light smearing of silicon sealant on the underside of the spacer will ensure a watertight fit.
4. Pass the two hoses through the 35mm hole and carefully locate the Head Assembly and black spacer on the bench / sink area.
5. From the underside of the bench / sink area install the S/S washer and "Spider Clamp" by feeding each of the two tubes and electrical cable evenly in between the legs of the "Spider Clamp". Slide it up to meet the "All Thread", and pass the "All Thread" through the centre of the "Spider Clamp".
6. Hold the "All Thread" steady and fit the 6mm nut to the "All Thread" using the tube spanner supplied in the kit. Check the Tap Head position before securing it tightly against the bench / sink top.

NOTE 1: The tap assembly must not be positioned more than 900mm above the base of the HydroTap unit.

Failure to do this may result in poor water delivery.

NOTE 2: Under no circumstances should the Tap be twisted after the installation is complete.

For Font installation procedure see page 8.

Installation procedure continued

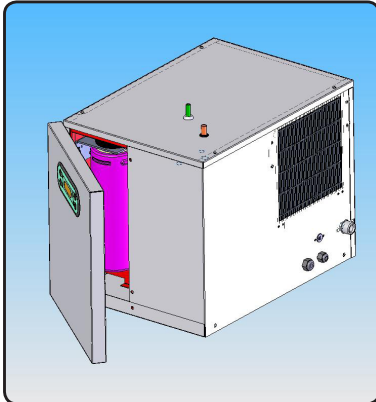

This instruction is critical →

Note:

Included in the installation pack are adhesive backed silicon buffers. If air vents are not installed in the cupboards housing the HydroTap, the buffers must be placed on the inside edge of the cupboard door to create a slight gap ensuring a minimum airflow. Failure to do this may cause the HydroTap to overheat and operate inefficiently.

Step B - Installing the undersink unit

SPECIAL NOTE: The HydroTap undersink units are heavy, take note of the weights listed in the table on page 4. If you think you cannot lift the unit safely, get help and avoid possible injury.

Before positioning the heater connect the braided water inlet hose (supplied) to the cold water inlet on the unit. This is located at the rear of the unit.

Position the Zip HydroTap undersink unit as close as possible to directly beneath the Zip HydroTap tap head.

The connection tubes supplied with the tap head assembly **CANNOT** be lengthened.

The system will operate satisfactorily only if the recommended air gaps are provided, these are 50mm minimum side clearance and 65mm rear clearance.

Adjust both cupboard door hinges and attach the supplied rubber door buffers to the doors to create a 4 mm air-gap between the doors and the cupboard. This is the minimum ventilation requirement for low usage installations.

Proper air circulation must be provided for all Chilled models. The system will operate correctly only if the recommended air gaps are achieved during installation. A ventilation hole measuring 100mm must be cut into the top half of the cupboard door to accommodate the air vent provided. Make sure that the undersink unit ventilation grilles are not obstructed in any way.

Step C - Connecting the tap

Measure and trim the blue tube and connect it to the chilled water outlet located on the top front, right hand side of the undersink unit. Use spring clamps provided.

Measure and trim the unmarked tube and connect it to the vent outlet.

NOTE: Both tubes must have a continuous fall back to the undersink unit.

Connect the tap USB connector to the USB port on the undersink unit. Orient the USB plug carefully and connect, do not force the plug. Once connected, fix the cable to the wall, ensure it is away from any possible water splashes and is off the floor.

Note: When trimming any silicon tubes trim to minimum length, do not loop any excess or allow kinking of the tubes. When connecting, slide the tube over the pipe at least 25mm. There are black plastic clamps provided on the chilled hoses to choke the flow if required. Only choke the flow if it is excessively strong.



Installation procedure continued

Use these buttons to scroll through the menu



Use these buttons to activate and de-activate the program selected



White Light
Filter Status

Blue Light
Chilled

Step D - Connecting the water supply

To prevent sediment from entering the Zip HydroTap at connection, flush water through the supply line thoroughly before connection to the Zip HydroTap. Open the access door and check that the filter is in place and secure. Connect the water supply to the undersink unit using the supplied flexible hose. Turn on water and check for leaks. If no leaks are evident turn the power on. The Blue L.E.D. flashes slowly on the Tap head assembly.

Step E - Testing and commissioning

Filter Flush Mode

The display screen will show which model you have.

Have a bucket or similar container (not supplied) at the ready to hold a quantity of water that is ejected while the Filter Flush Mode is in operation. Open the filter access door on the front of the HydroTap and the filter cartridge will be exposed. Located to the rear, right-hand side of the cartridge is a fixed flush line, approximately 600mm long and the flush line stop cock. Place the free end of the flush line into the bucket or container (not supplied).

The display will show Filter Flush Mode. Open the flush line stop cock. To activate press adjust \blacktriangle . Run at least 7.5 Litres of water through to activate the filter membrane. Press the adjust \blacktriangle button again to stop the Filter Flush Mode. Turn OFF the Filter Flush stop cock and re-locate the tube and stop cock in the filter compartment. Turning OFF the Filter Flush Mode puts the HydroTap into normal operation. Press adjust \blacktriangle to start normal operation.

Normal Operation

The compressor activates and water begins to fill the chiller tank at the prescribed rate.

When the water is chilled to 10 °C the Blue LED on the Tap Head assembly stops flashing and stays illuminated. The compressor continues to chill down to 5 °C when it will cycle Off.

Ensure that the clock matches your local time. If not refer to page 11. If Energy Saver Settings are required, the instructions for installing these are described on page 11 "Setting the Energy Saver Timer".

Font Installation Procedure

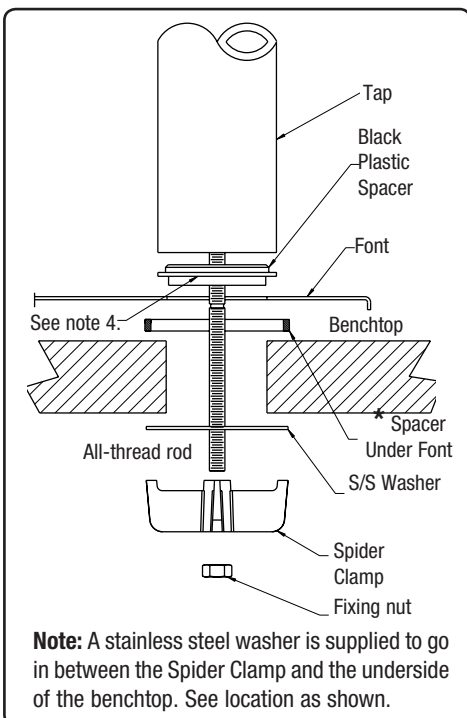
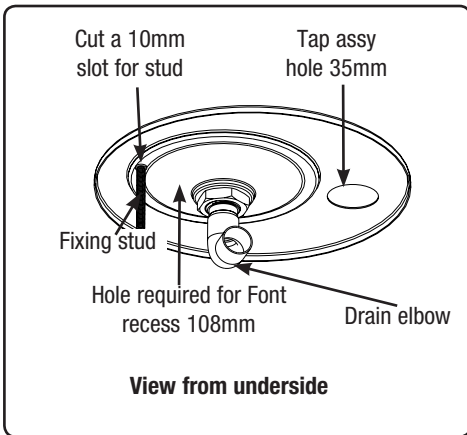

1. Position the Font template (provided) on the bench area. Ensure the position you select is within the length of the supply tube and USB cable fixed to the Tap Head Assembly. These cannot be extended.
2. Check again for correct positioning. The supply hoses must have constant fall back to the tank assembly. Cut the holes as shown on the template.
3. Once holes are cut, locate the Font base in position, from the underside, lightly tighten the securing rod with the nut and washer provided.
4. Apply a light smear of silicon sealant to the underside of the black plastic spacer, this will provide a water tight seal against the Font base when clamped.

* **Ensure that the plastic spacer is located under the font.**

5. Now take the Tap Head Assembly. Feed the hoses and USB cable through the Font base, then through the plastic spacer that is located between the underside of the font base and the bench top. This stops warping of the base plate. Ensure the Tap spout is directly centred over the Font drain. Fit the "Spider Clamp", nut and washer onto the "All Thread". Have all the supply tubes and USB cable located evenly between the "Spider Clamp" legs. When satisfied with the positioning, tighten the fixing nut with the Tube Spanner provided in the kit.

6. Tighten the securing pin so the Font base is flush with the bench top.

NOTE: The fixing nut above the drain elbow can be loosened to correctly position the direction of the elbow. Ensure when the re-positioning is complete the nut is re-tightened to ensure a water tight seal.

7. Connect a drain hose (22mm ID) from the Font base outlet elbow to the closest drain trap spigot available. If a spigot is not available use the snap on spigot and worm drive clamps supplied in the kit.
8. Ensure the positioning of the snap-on spigot is on the "sink" side of the trap and not the "waste" side. Once positioned, a hole (13mm ID) will need to be drilled to provide waste access to the drain line. The snap-on unit will require suitable sealant to keep it water tight against the waste pipe. Finish by fitting the worm drive clamps tightly on either side of the spigot and fitting worm drive clamps to either end of the drain hose. The drain hose from the Font must have constant fall.
9. Connect the Tap head Assembly supply hoses and vent as per the instructions contained in the installation procedure section of this document.

Operating the Tap



Blue Chilled Water Light

On all the time: This indicates that the unit is ON.

Flashing slowly

This indicates that the chilled water is not at the right temperature. Wait up to 20 minutes. When the chilled water is at the right temperature, the light will stop flashing. Note: The Zip HydroTap is designed to dispense chilled water in the temperature range 5 °C to 10 °C.

During heavy usage, the temperature can rise out of this range.

Filter Change Light Off

This indicates the filter is operating within its normal specified life-span.

Filter Change Light Flashing slowly

The light will flash slowly when the filter is due for replacement and the LCD will show "Filter Change". Refer to "Replacing the filter" section of this document.

Chilled Water Lever

Depressing the "Blue" lever allows dispensing of Chilled water.

Pulling up the Blue lever allows the tap to operate in a "no-touch" mode.

Water will flow from 5 to 15 seconds (factory preset to 15 seconds).

To reset, return the lever to the "Off" position and repeat the step. The lever has to be manually returned to the "Off" position.

Should an alternate dispensing time be needed refer to page 11, Water Dispensing.

Cleaning

Do not use strong, corrosive, spray or abrasive cleaners. Clean with a soft cloth or brush and mild soap and water.

Do not spray water over the tap as it may damage the low-voltage electronics.

Undersink units must never be located near or cleaned with water jets.

Replacing the Filter

The Zip HydroTap notifies when filter replacement is due. The default setting is 6000 Litres, but this can be set in increments of 1000 Litres from 1000 Litres to 10000 Litres. When a filter change is due, the Change Filter light will flash white once a minute and remain so until reset.

Depending on local water quality conditions and usage, the filter may require changing anywhere from 1000 Litres to 10000 Litres. You may also need to replace the filter if you notice unpleasant odours or tastes.

Some water may drip from the filter head (socket) during replacement. Keep a bucket and towel handy to catch drips and mop up any spills.

To change the Filter:

1. Scroll through the screen menu to "Filter Flush Off" this isolates the water supply.
2. Relieve system pressure via the filter flush stop cock, a quick open and close will do.
3. Grasp filter cartridge and twist right to left one quarter turn until it stops.
4. Ease cartridge downwards to detach it from the filter head (socket).
5. Do not tilt the cartridge as dirty water may spill from it if tilted.
6. Unpack replacement cartridge and write today's date where shown on the label.
7. Avoid touching the filter O-rings and filter opening as this may cause bacterial contamination of the cartridge.
8. Align cartridge tabs with the slots on the under-side of the filter head.
9. Slide cartridge upward into head and rotate left to right until it stops.
10. Locate the filter flush hose situated behind the filter cartridge and run to a container ready for flushing. Open the flush hose tap lever. On the control panel press adjust \blacktriangle , this will start the water flushing the cartridge. Allow at least 7.5 Litres of water to run through to activate the filter and then press adjust \blacktriangle to stop the flow.
11. Isolate the filter flush stop cock and re-fit behind the filter cartridge.
12. Wipe up any spills and dispose of spent filter cartridge and packaging thoughtfully.
13. Scroll through the menu to "Litres Filtered", press adjust \blacktriangle to reset litre counter. Then it asks "are you sure". Press adjust \blacktriangle again to lock in the command. After approximately 10 seconds it will default to the selected mode.

Warning: If the Zip HydroTap is switched off for a long period of time (e.g. more than a weekend), run water through the chilled water outlet for at least 5 minutes before consumption.

Setting the Energy Saver Timer (products with this feature only)

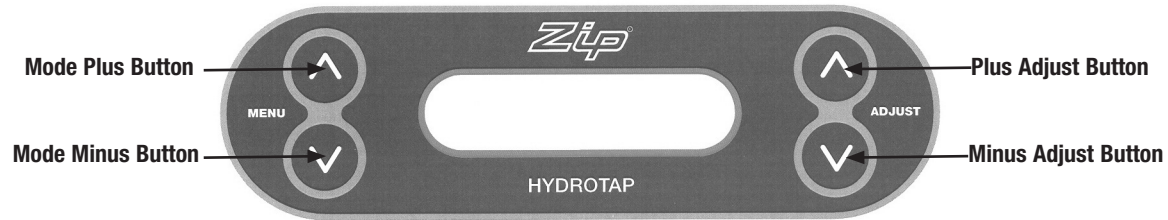

Normal Operation

Set Time

To change time, press either Mode \wedge or Mode \vee button until Set Time is on the display screen. Press \wedge Adjust button to increase time or \vee Adjust button to decrease time. Time increases or decrease in increments of one minute. Hold the Adjust buttons down for rapid increases or decreases. The time will be displayed in 24 Hr mode.

Set Day

Press either Mode \wedge or Mode \vee button until Set Day is displayed.

Press \wedge Adjust or \vee Adjust to select day.

Filter Life (factory set at 6000 Litres)

Press either Mode \wedge or Mode \vee button until Filter Life is displayed.

Press \wedge Adjust button to increase Filter Life or \vee Adjust button to decrease Filter Life.

Filter Life increases in 1000 Litres increments to a maximum of 10000 Litres.

Reset Litres Filtered

This function is to reset the Filter Change display after a filter has reached the end of its life (refer to "Replace Filter Instructions" section of this document).

Press either Mode \wedge or Mode \vee button until "Litres Filtered" is displayed.

Press \wedge Adjust once and "Reset Counter" will be displayed, press \wedge Adjust button once and "Are You Sure" will be displayed.

Press \wedge Adjust once and "Litres Filtered" will be reset to 0.

Activating On / Off Mode

Press the Mode \wedge or Mode \vee button until "Monday On" is displayed. To set the time for the unit to turn on press \wedge Adjust button until required time is reached.

To set the time for the unit to turn Off press Mode \wedge button once and "Monday Off" will be displayed. Now press \wedge Adjust until required time is reached.

If each individual day is to have an "On / Off" time, these steps need to be repeated for each day and for each On / Off time.

Water Dispensing Mode

This function allows the user to alter the preset time the water may be dispensed. This can go from 5 seconds to 15 seconds. (Factory set at 15 seconds)

To set, scroll through the menu to "Dispense Time", press adjust \wedge or \vee to the desired time frame.

Note: The Hydrotap may be temporarily activated during the On / Off Mode. By operating the levers, the unit will go into normal operation and then remain in an "ON" cycle, until the next "OFF" cycle.

Auxiliary Fan Attachment

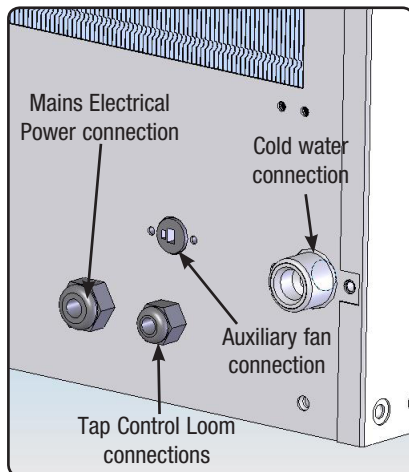

The HydroTap is equipped with an auxiliary fan connection point on the side panel close to the cold water inlet / flex and plug area. The fan kit is available as a spare part (part No. SP90651). The fan operates in parallel with the Condenser fan helping to remove heat from the cupboard space. This fan should be purchased and connected to the HydroTap if the airflow characteristics of the cupboard space are inadequate for the effective removal of hot air thereby adversely affecting the operation of the HydroTap.

The fan can be installed so that it extracts air from, or forces air into the cupboard space, whichever is the most effective for your installation.

Application of the fan is of paramount importance in situations where the cupboard space reaches temperatures greater than 35 °C.

The exhaust fan kit must be fitted, when supplied with the appliance.

Set the Cold Water Dispensing Times

The ability to change the maximum dispensing time for the Cold water has been introduced. The default settings for the maximum dispensing times is 15 seconds. The ability to change the Cold dispensing times between 5 to 15 seconds, in increments of 1 second, is accessible through the Menu screen on the LCD.

Scroll through the Menu until the Dispense Cold screen is displayed, then use the adjust buttons to set the required dispensing time for the Cold Water.

Trouble Shooting

Symptom	Possible Cause	Solution
No LED display, no tap head lights or, no water when tap levers are operated.	No power.	Check power supply.
	Plug is not located in power socket.	Ensure power plug is correctly fitted and switch is turned ON.
	Tap loom is not connected to HydroTap unit.	Check loom connection.
	Possible internal fault.	Contact local Zip Service Provider.
	Program in OFF cycle.	Check LCD for information.
No water flow.	Water supply isolated.	Check water supply is on.
	Water supply not connected.	Check to ensure plumbing connection is made.
	Power supply not connected.	Check power plug is correctly fitted and switch is turned on.
	Tap loom is not connected to HydroTap unit.	Check for loom connection.
	Possible internal fault.	Contact local Zip Service Provider.
	Program in OFF cycle.	Check LCD for information.
Slow water recovery after use.	Filter may require replacement.	Check filter usage on LCD screen, if "filter change" is displayed follow instructions on page 10.
Water not chilled.	Unit has just come out of OFF cycle.	Wait for Blue LED to stop flashing.
	Excessive use, unit refilling or chilling down to temperature.	Wait for Blue LED to stop flashing.
	Possible internal fault.	Contact local Zip Service Provider.
Alternating display messages.	More than one fault identified at the same time.	Record the number and type of faults Contact local Zip service Provider.

End of life disposal

In order to help preserve our environment we ask that you dispose of this product correctly.

Please contact Zip Customer Service for advice on 0845 602 4533

Exploded View Chiller Module and Spare Parts

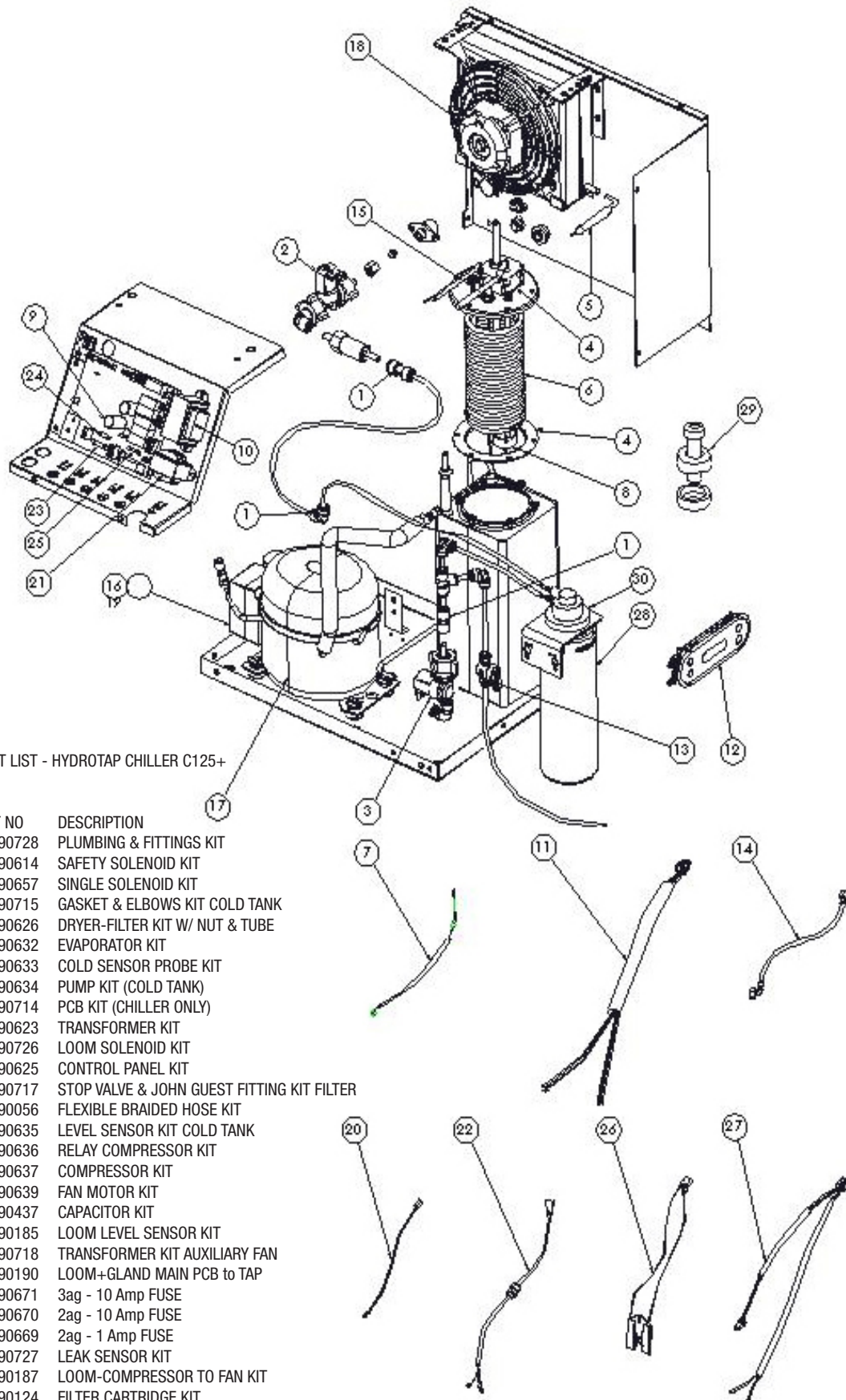

SPARE PART KIT LIST - HYDROTAP CHILLER C125+

ITEM	KIT NO	DESCRIPTION
1	SP90728	PLUMBING & FITTINGS KIT
2	SP90614	SAFETY SOLENOID KIT
3	SP90657	SINGLE SOLENOID KIT
4	SP90715	GASKET & ELBOWS KIT COLD TANK
5	SP90626	DRYER-FILTER KIT W/ NUT & TUBE
6	SP90632	EVAPORATOR KIT
7	SP90633	COLD SENSOR PROBE KIT
8	SP90634	PUMP KIT (COLD TANK)
9	SP90714	PCB KIT (CHILLER ONLY)
10	SP90623	TRANSFORMER KIT
11	SP90726	LOOM SOLENOID KIT
12	SP90625	CONTROL PANEL KIT
13	SP90717	STOP VALVE & JOHN GUEST FITTING KIT FILTER
14	SP90056	FLEXIBLE BRAIDED HOSE KIT
15	SP90635	LEVEL SENSOR KIT COLD TANK
16	SP90636	RELAY COMPRESSOR KIT
17	SP90637	COMPRESSOR KIT
18	SP90639	FAN MOTOR KIT
19	SP90437	CAPACITOR KIT
20	SP90185	LOOM LEVEL SENSOR KIT
21	SP90718	TRANSFORMER KIT AUXILIARY FAN
22	SP90190	LOOM+GLAND MAIN PCB TO TAP
23	SP90671	3ag - 10 Amp FUSE
24	SP90670	2ag - 10 Amp FUSE
25	SP90669	2ag - 1 Amp FUSE
26	SP90727	LEAK SENSOR KIT
27	SP90187	LOOM-COMPRESSOR TO FAN KIT
28	SP90124	FILTER CARTRIDGE KIT
28	SP90211	FILTER BYPASS
29		ø35mm CHASSIS PUNCH - SUPPLIED WITH TAP
30	SP99108	FILTER HEAD KIT

Notes

Notes

Warranty

Certain warranties may be implied by law into your contract with Zip. The warranty provided below is additional to these implied warranties and nothing set out below shall limit your statutory rights or rights at law.

Zip Heaters UK Ltd warrants that, should any part fail within 12 calendar months of installation, that part will be repaired or replaced free of charge by Zip or its Distributor or Service Provider, except as set out below, provided the appliance is installed and used strictly in accordance with the instructions supplied, and that failure is not due to accident, misuse, abuse, unsuitable water conditions, or to any alteration, modification or repair by any party not expressly nominated by Zip.

No costs are payable by the customer other than any mileage or travelling-time charges incurred by a Zip Service Provider or the cost of removal, cartage and re-installation of any component of the appliance if it needs to be returned for repair to Zip or its Distributor.

This warranty does not cover damage resulting from non-operation of the appliance, the use of non-authorised parts or consequential damage to any other goods, furnishings or property.

No warranty applies to the life of any filtration cartridge installed with the appliance as cartridge life may vary according to water quality and the rate of water consumption.

Zip does not exclude, restrict or modify any liability that cannot be excluded, restricted or modified or which cannot, except to a limited extent, be excluded, restricted or modified as between the owner or user and Zip under the laws applicable.

Furthermore, this warranty does not displace any statutory warranty, but, to the extent to which Zip is entitled to do so, the liability of Zip under any statutory warranty will be limited at Zip's option to the replacement of the appliance or supply of equivalent appliance, the payment of the cost of replacing the appliance or acquiring an equivalent appliance, or the payment of the cost of having the appliance repaired or the repair of the appliance.

As Zip policy is one of continuous product improvement, changes to specifications may be made without prior notice. Images in this booklet have been modified and may not be true representations of the finished goods.

The standard glass is 200 ml (7 fl oz).

The terms "Zip" and "HydroTap" are registered trade marks of Zip Heaters (Aust) Pty Ltd.

Zip products described in this publication are manufactured under one or more of the following patents:

AU675601, AU637412, AU635979, GB0422305, GB2065848, US4354049, US5103859, US5099825 and SA2006/08043. Other patents are in force and patent applications are pending.

Contact Details

Head Office

Zip Heaters (UK) Ltd
14 Bertie Ward Way
Dereham
Norfolk NR19 1TE

Website: www.zipheaters.co.uk
sales@zipheaters.co.uk
Telephone: 0845 602 4533
Facsimile: 01362 692 448.



Registering Your Purchase

Registering your Zip installation on the Zip website may help to establish date of installation should it become necessary to service the appliance under terms of the Zip warranty. To register your installation go to www.zipheaters.co.uk and look under the heading "Register Product".